



STEAM EQUIPMENT

## FLOAT AND THERMOSTATIC STEAM TRAPS FLT 17 HC ( High Capacity ) ( Cast Iron DN 25 - 1" )

### DESCRIPTION

FLT 17 float and thermostatic (integral air vent) steam traps series are designed for all types of low and high pressure steam heating and process equipment.

Typical applications include unit heaters, heat exchangers, driers, jacketed vessels and all the applications where continuous drainage is essential. Connections are female screwed or flanged for horizontal or vertical installation.

### MAIN FEATURES

Modulating discharge.

Discharges condensate at steam temperature.

Unaffected by sudden or wide load and pressure changes.

Excellent air discharge (by thermostatic air vent).

**OPTIONS:** Internal strainer (only on horizontal models).  
SLR - steam lock release .  
Equalizing plug ,venting connection and drain plug ( or blow-off valve on body).

**USE :** Saturated and superheated steam.

### AVAILABLE

**MODELS :** FLT17HC-4.5 - FLT17HC-10 - FLT17HC-14.

**SIZES :** DN 1" - DN 25.

**CONNECTIONS :** Female screwed ISO 7/1 Rp (BS21)

Flanged DIN. Special flanges upon request.

**INSTALLATION :** Standard horizontal installation -  
flow from left to right FLT17 (L-R)

Upon request:

-horizontal installation with the flow from right to left FLT17 (R-L)

-vertical installation with the flow from top to bottom FLT17 (V)

See IMI, installation and maintenance instructions.

PMA :Max.allowable pressure 16 bar

TMA: Max.allowable temperature 250 °C

PMO: Max.operating pressure 14 bar

TMO: Max.operating temperature 198 °C

How to order: i.e. FLT 17HC -14 DN 1" BSP.

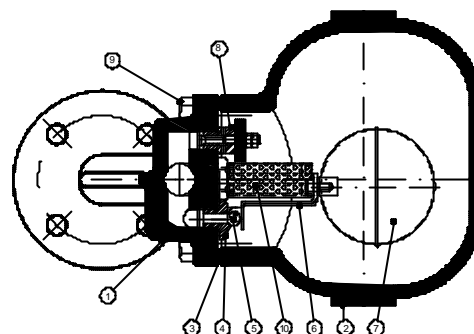

### MATERIALS:

POS.NR.	DESIGNATION	MATERIAL
1	BODY	GGG 40
2	COVER	GGG 40
3 *	GASKET	NON ASBESTOS
4 *	SEAT	AISI 410
5 *	VALVE	AISI 410
6 *	LEVER	AISI 304
7 *	FLOAT	AISI 304
8 *	AIR VENT	STAINLESS STEEL
9	BOLTS	STEEL 8.8
10	STRAINER	AISI 304

\* AVAILABLE SPARE PARTS

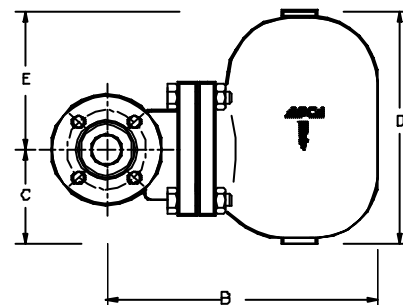

Max.differential pressure  
FLT 17HC-4.5 - 4.5 bar  
FLT 17HC -10 - 10 bar  
FLT 17HC- 14 - 14 bar

### DIMENSIONS (mm)

SIZE	Screwed Ends					WEIGHT	Din Flanges		
	A	B	C	D	E		F	B	WEIGHT
DN	Kg								
1"	120	195	80	200	110	9	160	245	11,3

### FLOW RATE CAPACITY IN Kg/h

MODEL SIZE	DIFFERENTIAL PRESSURE (bar)												
	0,5	1	1,5	2	3	4,5	6	7	8	9	10	12	14
FLT17HC-4,5 1"	900	1250	1450	1700	2010	2400							
FLT17HC- 10 1"	390	550	675	790	900	1000	1200	1300	1400	1500	1590		
FLT17HC-14 1"	250	350	430	500	590	680	800	850	900	950	1000	1000	1150

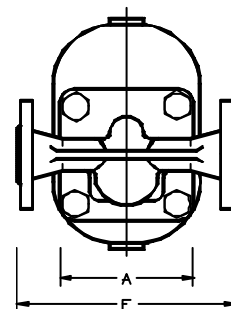

Recommended safety factor : continuous 1.2 - 1.5 ; discontinuous flow 2 - 3 .

**VALSTEAM ADCA**

We reserve the right to change the design and material of this product without notice.



Produced in accordance with Article 3, paragraph 3 of the PED - European Pressure Equipment Directive - 97/23/EC.  
Produzido em conformidade com o Artigo 3º, parágrafo 3 da PED -Directiva Europeia 97/23/EC ( Decreto-Lei 211/99 ) .

IS 1.345 E 06.01