

INVERTED BUCKET STEAM TRAPS IBB 12

DESCRIPTION

IBB 12 series inverted bucket steam traps are recommended for all services where the most important requirements are overall operating efficiency and long, trouble-free service life.

They operate intermittently, either wide open or tightly closed and are therefore best suited for service at medium and high steam pressures. Connections are female screwed horizontal.

MAIN FEATURES

- Intermittent discharge.
- Discharges condensate at steam temperature.
- Unaffected by waterhammer and vibrations.
- Easy to maintain.
- Built-in strainer.

- USE : Saturated and superheated steam.
- AVAILABLE MODELS : IBB12-4 ; IBB12-8 - IBB12-12.
- SIZES : 3/4" and 1"
- CONNECTIONS : Female screwed ISO 7/1 Rp (BS21)
- INSTALLATION : Horizontal installation.
See IMI, installation and maintenance instructions.
- MAX.D.PRESS.: IBB12- 4 - 4 bar
IBB12- 8 - 8 bar
IBB12-12 -12 bar

- PMA :Max.allowable pressure 16 bar
TMA: Max.allowable temperature 250 °C
PMO: Max.operating pressure 14 bar
TMO: Max.operating temperature 230 °C

How to order : i.e. IBB12-8 DN 1" BSP

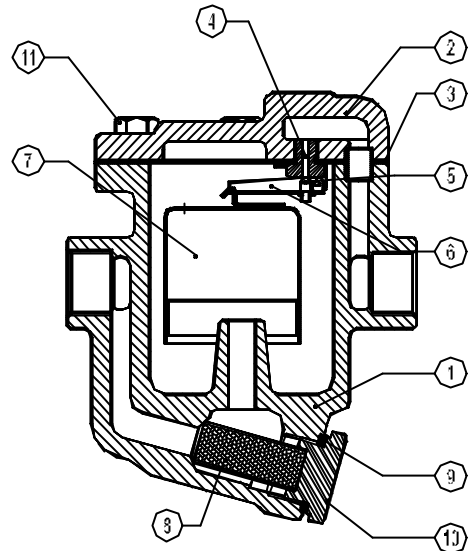

| MATERIALS: | | |
|------------|-----------------|--------------|
| POS.NR. | DESIGNATION | MATERIAL |
| 1 | BODY | GGG40 |
| 2 | COVER | GGG40 |
| 3 * | GASKET | NON ASBESTOS |
| 4 * | SEAT | AISI 410 |
| 5 * | VALVE | AISI 410 |
| 6 * | LEVER | AISI 304 |
| 7 * | BUCKET | AISI 304 |
| 8 * | STRAINER SCREEN | AISI 304 |
| 9 | GASKET | 316/GRAPHITE |
| 10 | PLUG | C22.8 |
| 11 | BOLTS | STEEL 8.8 |

* AVAILABLE SPARE PARTS

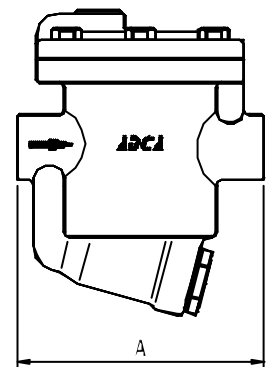
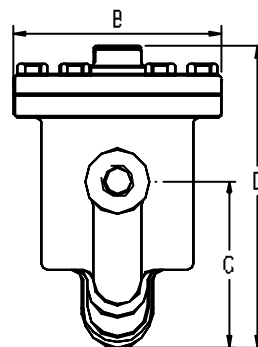

FLOW RATE CAPACITY IN Kg/h

| MODEL | SIZE | DIFFERENTIAL PRESSURE (bar) | | | | | | | | | | | | | | |
|----------|---------|-----------------------------|------|------|------|------|------|------|------|------|------|------|------|------|------|------|
| | | 0.5 | 1 | 2 | 3 | 4 | 5 | 6 | 7 | 8 | 10 | 11 | 12 | 13 | 15 | 17 |
| IBB12-4 | 3/4"-1" | 790 | 1090 | 1380 | 1550 | 1670 | | | | | | | | | | |
| IBB12-8 | 3/4"-1" | 520 | 725 | 910 | 1030 | 1100 | 1160 | 1210 | 1250 | 1290 | | | | | | |
| IBB12-12 | 3/4"-1" | 410 | 570 | 720 | 810 | 860 | 920 | 950 | 985 | 1010 | 1060 | 1080 | 1100 | 1120 | 1150 | 1690 |

| DIMENSIONS (mm) | | | | | |
|-----------------|-----|-----|-----|-----|--------|
| SIZE | A | B | C | D | WEIGHT |
| DN | | | | | Kg |
| 3/4" | 175 | 150 | 127 | 219 | 7 |
| 1" | 175 | 150 | 127 | 219 | 6,9 |

Recommended safety factor: continuous service = 1.2 - 1.5 ; discontinuous service = 2-3.